

# Rotary Paddle Level Switch

## Product Description

The rotary switch is a level controller for solid materials (including powder, block, granule, gelatin, etc.). It is characterized by good sealing, strong overload capacity, lightweight and easy to install, and large output contact capacity. For different specific gravity materials can be realized by adjusting the tension of the spring, and its contact material part is all stainless steel. The rotary switch is widely used in chemical, plastic, cement, pharmaceutical, feed, food and other industries.

## Product features

1. American small hopper professional technology, three bearing support, more reliable operation;
2. The original sealing design can prevent dust infiltration (patented actual).
3. Stable and reliable torque and adjustable torque size;
4. The blade is subjected to excessive load and the clutch slips automatically to protect the motor from damage;
5. Electromechanical separated structure, the whole disassembly-free and easy maintenance;
6. IP65 protection level of the junction box, good sealing, can be used outdoors;
7. Special blades can be used in low-density materials;
8. Wide range of use, can be used in steel, cement, electricity, feed, chemical plastics, chemical fertilizers, etc..  
Chemical fertilizer and so on;

## Working Principle

The motor drives the blade to rotate, when the measured medium reaches the position of the blade, the blade is blocked and stops rotating, thus triggering the micro switch at the back to output the switching signal, when the measured medium drops and leaves the blade, the blade resumes its original position and continues to rotate under the action of the spring. The tension of the spring can be adjusted according to the specific gravity of the measured medium, when the material is larger than the spring is adjusted to the strongest, and vice versa, the spring is adjusted to the weakest.

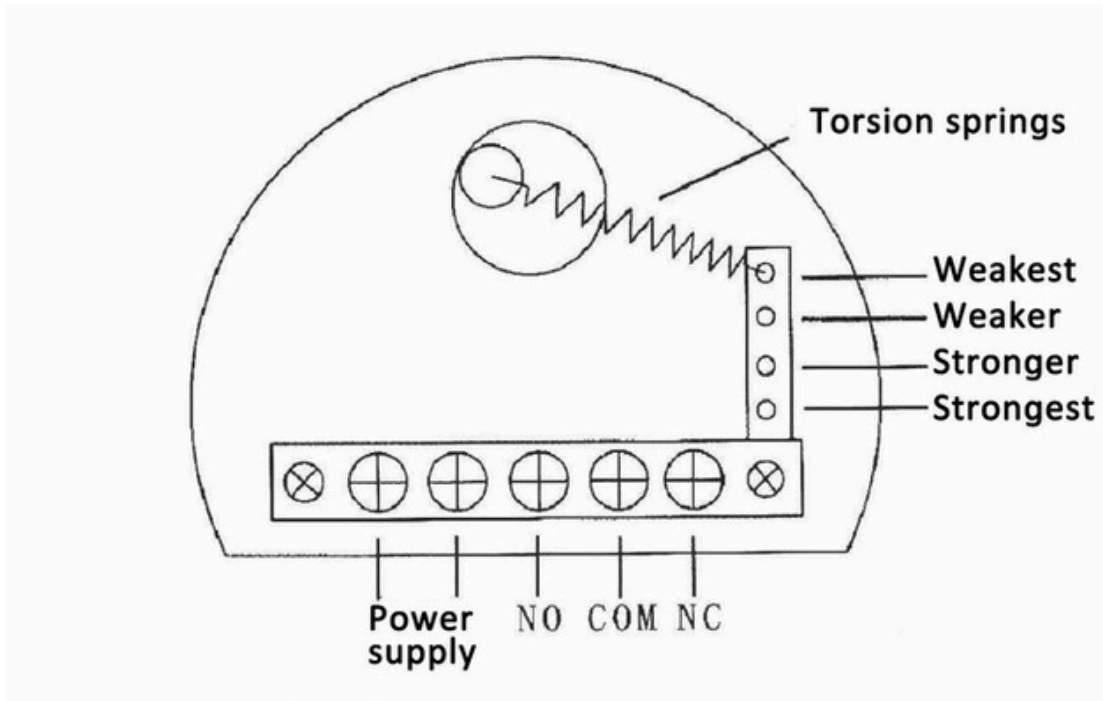

**ISEN30 Series Wiring Instructions**

## Technical Parameters

ITEM	PARAMETER
Power supply	220VAC/110VAC/24VAC/24VDC
Contact capacity	250VAC/10ASPDT (single-pole double-throw)
Power	4W
Blade speed	1RPM (rpm)
Torque	1.0kg×cm
Material specific gravity	≥ 0.5g/cm <sup>3</sup>
Operating temperature	- 10 °C -80 °C (up to 400 °C)
Insulation resistance	≥100MΩ
Dielectric strength	1500V*1min
Protection grade	IP65
Blade material	SUS30 4

## Selection Guide

Model: ISEN 20/21/60/62:L=100mm ; Model: ISEN 30/61:L=250mm;

Model: ISEN 50/63:L=650mm;

Length can be customized according to customer requirements.

<p><b>ISEN10 Small Hopper Type</b></p>	<p><b>ISEN20 Standard Thread Mounting Type</b></p>	<p><b>ISEN21 Standard Flange Mounting Type</b></p>
<p><b>ISEN30 Shaft Protection Pipe Type</b></p>	<p><b>ISEN50 Shaft Length Adjustable</b></p>	<p><b>ISEN60 High Temperature Threaded Type</b></p>
<p><b>ISEN61 High Temperature Protection Pipe Type</b></p>	<p><b>ISEN62 High Temperature Flange Type</b></p>	<p><b>ISEN63 Steel Cable Type</b></p>



Model	Small Hopper Type		
	<b>Connected Shaft Form</b>		
	0	Standard Thread Mounting Type	
	1	Standard Flange Mounting Type	
	2	Shaft Protection Pipe Type	
	3	High Temperature Threaded Type	
	4	High Temperature Flange Type	
	5	High Temperature Protection Pipe Type	
		<b>Blade Type</b>	
		A	85*35(WXH)
		D	Scythe-shaped
			<b>Power Supply</b>
		1	220VAC
		2	24VDC

Model	Standard Type		
	<b>Connected Shaft Form</b>		
	0	Standard Thread Mounting Type	
	1	Standard Flange Mounting Type	
	2	Shaft Protection Pipe Type	
	3	High Temperature Threaded Type	
	4	High Temperature Flange Type	
	5	High Temperature Protection Pipe Type	
	6	Shaft Length Adjustable	
	7	Steel Cable Type	
		<b>Blade Type</b>	
		A	100*30(WXH)
		B	65*80(WXH)
		C	50*30(WXH)
		D	Scythe-shaped
			<b>Power Supply</b>
		1	220VAC
		2	110VAC
		3	24VAC
		4	24VDC

Remarks: Blade Type

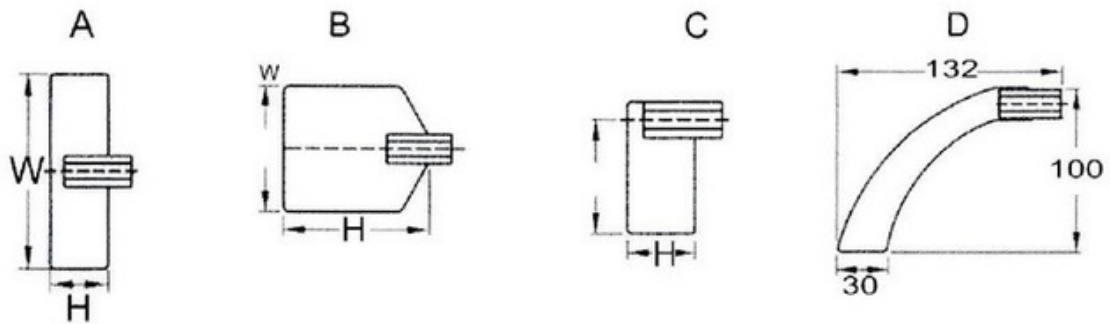

**VALVELink**  
All your process control needs

**Công ty TNHH Valvelink**

Số 399 Nguyễn Thị Kiều, phường Tân Thới Hiệp, Quận 12, TP Hồ Chí Minh.

**Valvelink (ASEAN)**

1-20-02, M-City Ampang, Jalan Ampang, 57450 Kuala Lumpur Malaysia.

Facebook



Website



Zalo



**Valvelink (EUROPE)**

Hakkı Yeten Cad. Selenium Plaza No:10, 1 Kat:5-6 34349 Fulya Beşiktaş, İstanbul, İstanbul - Şişli, 34349, Turkey.

**Valvelink (CHINA)**

B Unit 1F A Building No.5 Zi Yang Road Nankai District Tianjin China.