

Pneumatic carbon steel mechanical flange ball valve

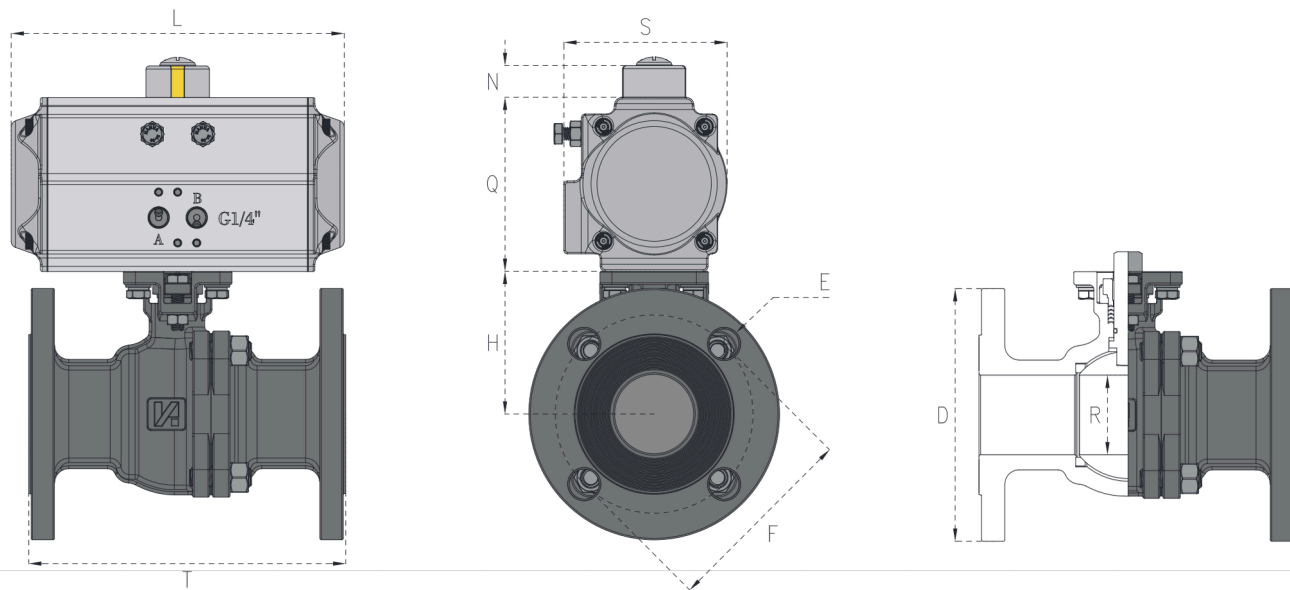

|                            |   |
|----------------------------|---|
| Model number               | VMQ641F-16C (PTFE+WCB)<br>VMQ641M-16C (PPL+WCB)     |
| Design standard            | GB/T12237-2007                                      |
| Applicable temperature     | -20~+150°C/-18~+260°C                               |
| Air source pressure        | 0.4~0.75Mpa   |
| Connection form            | Flange  |
| Connection standard        | GB/T9113.1-26                                       |
| Test pressure              | 1.76Mpa (Watertight seal) / 0.6Mpa (air-tight seal) |
| Structural characteristics |   |

Shape And Connection Size



| specification | Actuator type matching | dimensioning code |     |       |    | pressure: 1.6mpa |      |       |     | unit: mm |     |
|---------------|------------------------|-------------------|-----|-------|----|------------------|------|-------|-----|----------|-----|
|               |                        | L                 | T   | S     | N  | Q                | H    | E     | F   | D        | R   |
| DN15          | AT52                   | 147               | 130 | 71.5  | 20 | 72               | 52.5 | 4×Φ14 | 65  | 95       | 15  |
| DN20          | AT52                   | 147               | 140 | 71.5  | 20 | 72               | 54.5 | 4×Φ14 | 75  | 105      | 20  |
| DN25          | AT63                   | 168               | 150 | 83    | 20 | 88               | 58.5 | 4×Φ14 | 85  | 115      | 25  |
| DN32          | AT75                   | 186               | 165 | 95    | 20 | 99.5             | 71   | 4×Φ14 | 100 | 135      | 32  |
| DN40          | AT83                   | 212               | 180 | 103   | 20 | 108.7            | 76   | 4×Φ18 | 110 | 145      | 40  |
| DN50          | AT83                   | 212               | 200 | 103   | 20 | 108.7            | 90   | 4×Φ18 | 125 | 160      | 50  |
| DN65          | AT105                  | 268               | 220 | 121.5 | 20 | 133              | 107  | 4×Φ18 | 145 | 180      | 65  |
| DN80          | AT105                  | 268               | 250 | 121.5 | 20 | 133              | 118  | 8×Φ18 | 160 | 195      | 80  |
| DN100         | AT125                  | 301               | 280 | 142   | 30 | 155              | 138  | 8×Φ18 | 180 | 215      | 100 |

Actuator matching is for reference only, please contact the manufacturer for more diameter sizes or other sizes.

Materials For Main Part

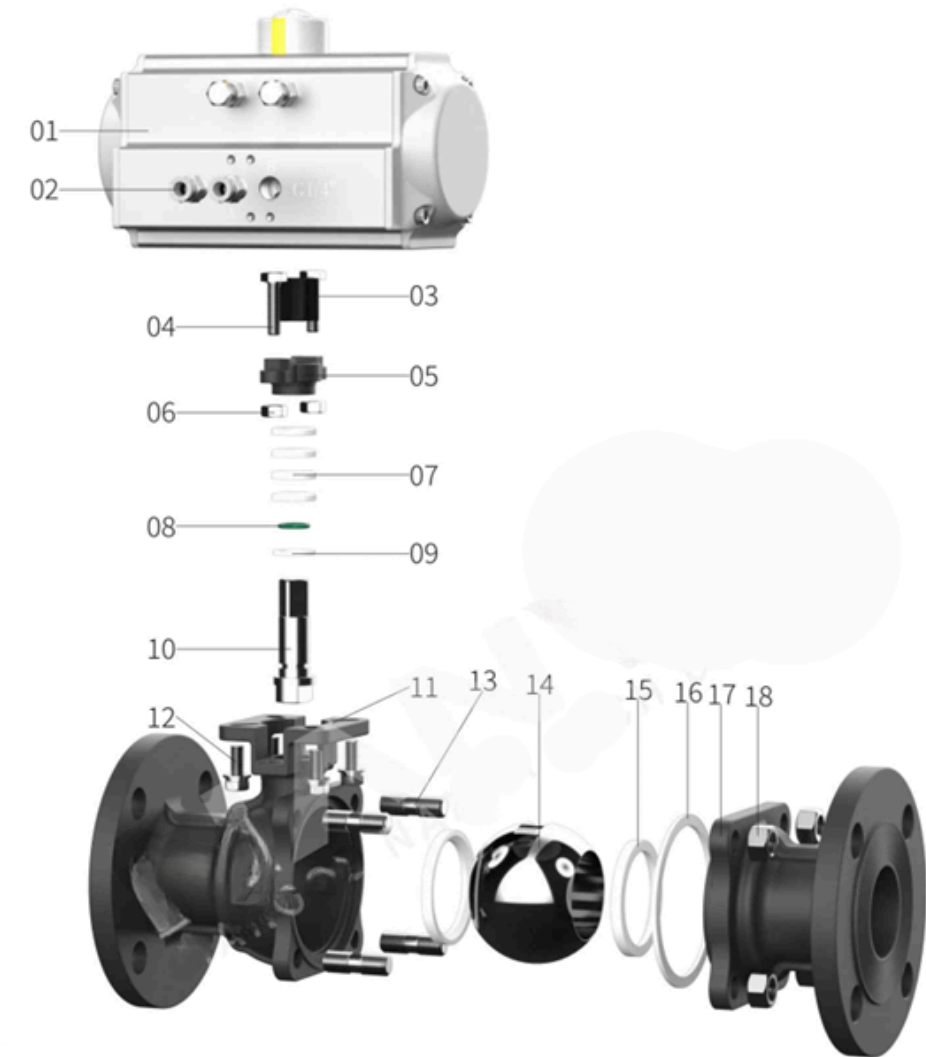

| ID | Quantity | Part name           | Main material |
|----|----------|---------------------|---------------|
| 01 | 1        | Pneumatic actuator  |               |
| 02 | 2        | Pack alloy          |               |
| 03 | 0/1      | Air connection      |               |
| 04 | 2        | Copper plating      |               |
| 05 | 1        | Octagonal bushing   |               |
| 06 | 2        | Powder metallurgy   |               |
| 07 | 4        | Gland screw         |               |
| 08 | 1        | 35#                 |               |
| 09 | 1        | Gland               |               |
|    |          | WCB                 |               |
|    |          | Gland nut           |               |
|    |          | 35#                 |               |
|    |          | Padding             |               |
|    |          | PTFE / PPL          |               |
|    |          | O-ring              |               |
|    |          | FKM / EPDM          |               |
|    |          | Prevent push gasket |               |
|    |          | PTFE                |               |

| ID | Quantity | Part name                  | Main material |
|----|----------|----------------------------|---------------|
| 10 | 1        | Valve shaft                | 20Cr13        |
| 11 | 1        | Valve body                 | WCB           |
| 12 | 4        | Combination screw          | SUS304        |
| 13 | 4~16     | Valve side cover nut       | 35#           |
| 14 | 1        | Ball                       | 20Cr13        |
| 15 | 2        | Valve seal                 | PTFE          |
| 16 | 1        | Valve side cover is sealed | PTFE / PPL    |
| 17 | 1        | Valve side cover           | WCB           |
| 18 | 4~16     | Nut                        | 35#           |